

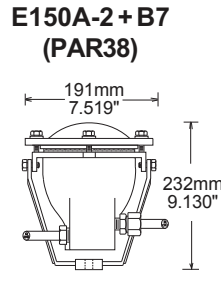

SUBMERSIBLE LIGHTFIXTURE **PEM E150**

FOR USE WITH REFLECTOR LAMPS

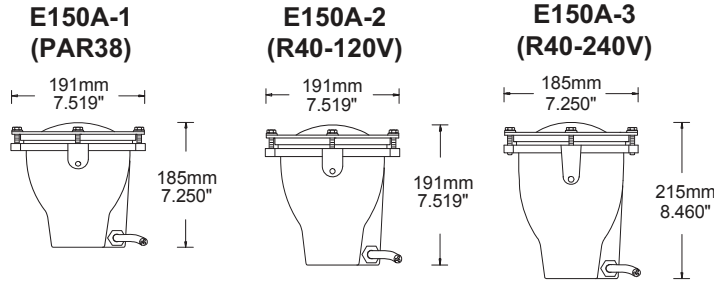

E150A-2 + 10-2 + B1

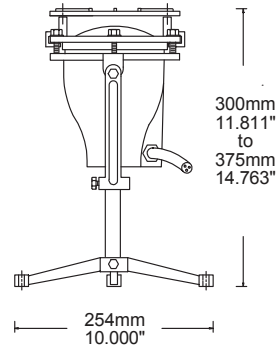

E150A-3 + 10-7 + B4

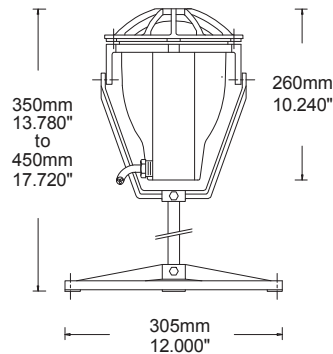

E150A-1 + 10-6

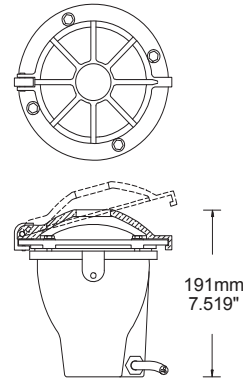

E150A/B1

CONSTRUCTION OF LIGHTFIXTURE:

HOUSING & FACERING:

Cast bronze, Stainless Steel fitted.
Facering states tightening torque for facering bolts.

LAMP: OPTIONAL

Select E150 Fixture for lamp length (MOL) available.
Verify with supplier the availability of suitable Reflector Lamps.
See above and see opposite page.

LAMP HOLDER:

E27/E26, Ceramic screw socket with copper alloy screw shell and parts.

LENS: 143mm / 5.625" Diameter. See Lightfixture Supplement, Lenses

STANDARD: Convex cast glass, heat resistant and tempered.
Clear or 5 colors.

OPTIONAL: Convex Dichro Colour Lens, in 10 colours

OPTIONAL: Lens Shade for Dichro Colour Lens

LENS GASKET:

Molded, single piece 'U' shaped gasket of EDM for submerged use,
High temperature silicone rubber (optional) for dry use.

THERMAL CUT-OFF: OPTIONAL,

Specify /-07 Available for 120V-240V fixtures only.

CABLE: Approved for the purpose. Electrical cable with epoxy encapsulated compression type cable entry into housing. See Lightfixtures Supplements for cable sizing

ROCKGUARD OR LENS GUARD: OPTIONAL

See opposite page

STAND OR MOUNTING ASSEMBLY: OPTIONAL.

See opposite page

E150-C (PAR38)

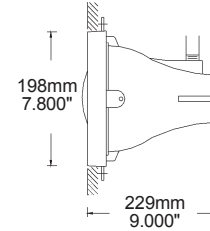

CAST INTO WALL FIXTURE
with 1/2" / 12mm conduit connection. No Cable



E150A/-10-6/-B1

APPROVALS For Submerged use except E 150 C
cUL - 120 / 24 & 12V
CS - 240 / 24 & 12V
UL - 120 / 24 & 12V

E150-A1 & 2 + B50A
B50A WALK OVER WET NICHE

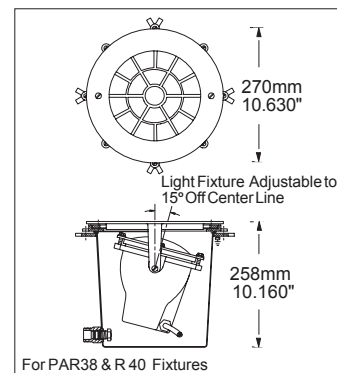

E150-A1 + 10-7 + B46

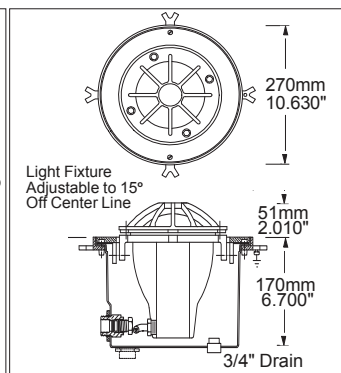

E150A + B57 B57 Slab Hanger **E150A + B56-1 B56 on Pipe Stand (10" PVC Pipe, by others)** **E150A + B56 B56 Slab Hanger**

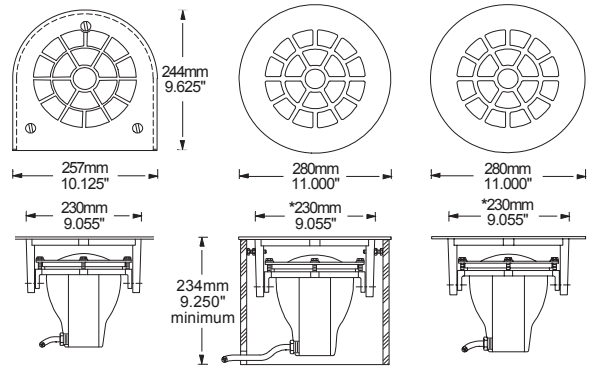

* Inside diameter of circular opening in floor or deck